

Head Office:
Dixon Kelley Estate Agents
1 Penn Court
Station Road, West Moors
Dorset. BH22 0JJ

DORSET PARK HOMES

DRAFT

www.dorsetparkhomes.com

Telephone: 01202 877511

33 The Paddock, Oaktree Park, St Leonards, Nr Ringwood. BH24 2RW



Spacious Park Home on Good Plot

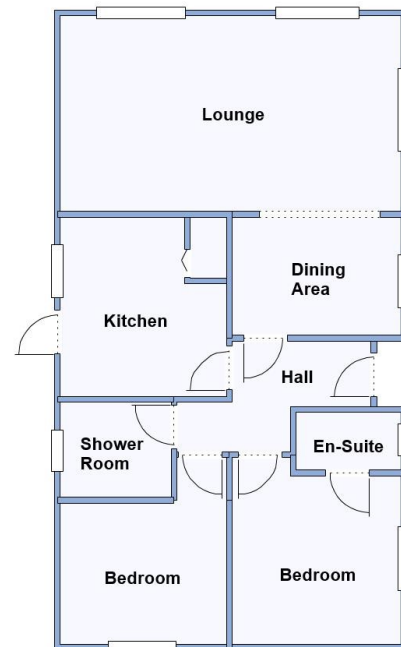

This drawing has been prepared for diagrammatic purpose only. Not to scale.

2-Bedroom Park Home - approx 36' x 20'

Accommodation & approximate room dimensions:

- Twin Unit Wonderland Park Home approx 1997
- Entrance Hall
- Kitchen: approx 10'4" x 9'4". Range of floor and wall cupboards. Built-in oven, hob & cooker hood. Space for tall fridge/freezer & washing machine. Cupboard housing combination gas boiler. Door to garden.
- Dining Area: approx 9'8" x 6'9".
- Lounge: approx 19'5" x 11'2". Feature fireplace.
- Bedroom 1: approx 10'1" x 9'4". Built-in wardrobes.
- En-Suite Cloakroom (with space for shower)
- Bedroom 2: approx 9'4" x 8'1". Built-in wardrobes.
- Shower Room: Modern suite with large shower cubicle. Vanity wash basin & WC. Heated towel rail.
- Gas Central Heating (system untested)
- PVCu Double-Glazing
- Paved Patio Garden with Metal Shed
- Parking on Plot
- Age Restriction 50+ Pets Considered
- Well maintained Residential Park with active Members Club. Located between Ringwood & Ferndown.
- No Chain!

Popular 'Pet Friendly' Park



Pitch Fee: approx £208.24 per cal month

Subject to Annual Review

Council Tax Band: 'A' Tenure: 1983 Mobile Homes Act Agreement

Price: £149,950

VIEWING STRICTLY BY APPOINTMENT WITH THE VENDOR'S AGENT Dorset Park Homes 01202 877511

IMPORTANT NOTE: These particulars are believed to be correct but their accuracy is not guaranteed. They do not form part of any contract. Nothing in these particulars shall be deemed to be a statement that the property is in good structural condition or otherwise, nor that any of the services, appliances, equipment or facilities are in good working order or have been tested. Purchasers should satisfy themselves on such matters prior to purchase Ref.W04629

The recommended specialist in Park Home sales
Partner: Simon Dixon

